



October 26, 2011
Southeast Kansas Education Service Center

Sponsored by:



School Law Clinic – 8:45 a.m. Registration; 9:15-11:15 meeting (*IDL Room*)

NBMW – 9 a.m. Registration; 9:30 a.m. – 3:15 p.m. adjourn; Lunch with Summit (*RVH Conf. Room*)

11 a.m. **Registration/Lunch** (*Lobby*)

11:30 a.m. **Key Education Leaders - Panel Discussion** (*Rooms ABC*)

Dr. Diane DeBacker, KSDE Commissioner of Education
Dr. Gary Alexander, Vice President for Academic Affairs, KBOR
Cheryl Semmel, USA/Kansas Executive Director
Dr. John Heim, KASB Executive Director

1 p.m. **Break**

1:15 p.m. **Breakout Sessions**

KASB Clerks Session (*North Conf. Room*)

Jim Hays, KASB Research Specialist

Advocacy and Community Engagement/Effective Communications (*Green Room*)

Mark Tallman, KASB Associate Executive Director/Advocacy

Carol Pitts, KASB Assistant Executive Director/Marketing & Communications

Tom Krebs, KASB Governmental Relations Specialist

21st Century Accreditation Model for Districts (*IDL Room*)

Brad Neuenswander, KSDE Deputy Commissioner for Learning Services

State of Kansas Education (*Rooms ABC*)

Dr. Diane DeBacker, KSDE Commissioner of Education

College Readiness (*RVH Training Room*)

Dr. Gary Alexander

2:15 p.m. **Break**

2:30 p.m. **Breakout Sessions**

KASB Clerks Session, continued (*North Conf. Room*)

21st Century Parent Involvement (*Green Room*)

Jane Groff, Kansas Parent Information Resource Center, Director

21st Century Accreditation Model for Districts (*IDL Room*)

Brad Neuenswander

State of Kansas Education (*Rooms ABC*)

Dr. Diane DeBacker

Higher Education in Kansas (*RVH Training Room*)

Dr. Gary Alexander

Community Engagement for School Leaders (*Community Center*)

Cheryl Semmel

3:15 p.m. **Break**

3:30 p.m. Organizational Business Meetings
USA | Kansas (*North Conf. Room*) (*Rooms IDL & Green if necessary*)
KASB Meeting (*Rooms ABC*)
Nominating Committee Report/Candidate Videos
Constitutional Amendment
Executive Directors Report
Legislative Committee Report
Study Group Reports

5 p.m. Break

5:15 p.m. Breakout Sessions
Advocacy (*Green Room*)
Mark Tallman
Learning Forward - Standards for Professional Learning (*IDL Room*)
Santee Crowther, Kansas Learning Forward
The Kansas Budget and School Finance (*Rooms ABC*)
Dale Dennis, KSDE Deputy Commissioner/School Finance
Craig Neuenswander, KSDE Director/School Finance

5:45 p.m. Break

6:00 p.m. Breakout Sessions
Communicating Change: NCLB, School Finance (*Green Room*)
Carol Pitts
Kansas Educational Leadership Initiative (*IDL Room*)
Mary Devin, KELI Executive Director
The Kansas Budget and School Finance (*Rooms ABC*)
Dale Dennis
Craig Neuenswander

6:30 Adjourn Breakout Sessions

6:45 p.m. Dinner (*Rooms ABC*)
Kansas Conversation – The People Speak

Dave DeMoss Center For Learning (Main Building)

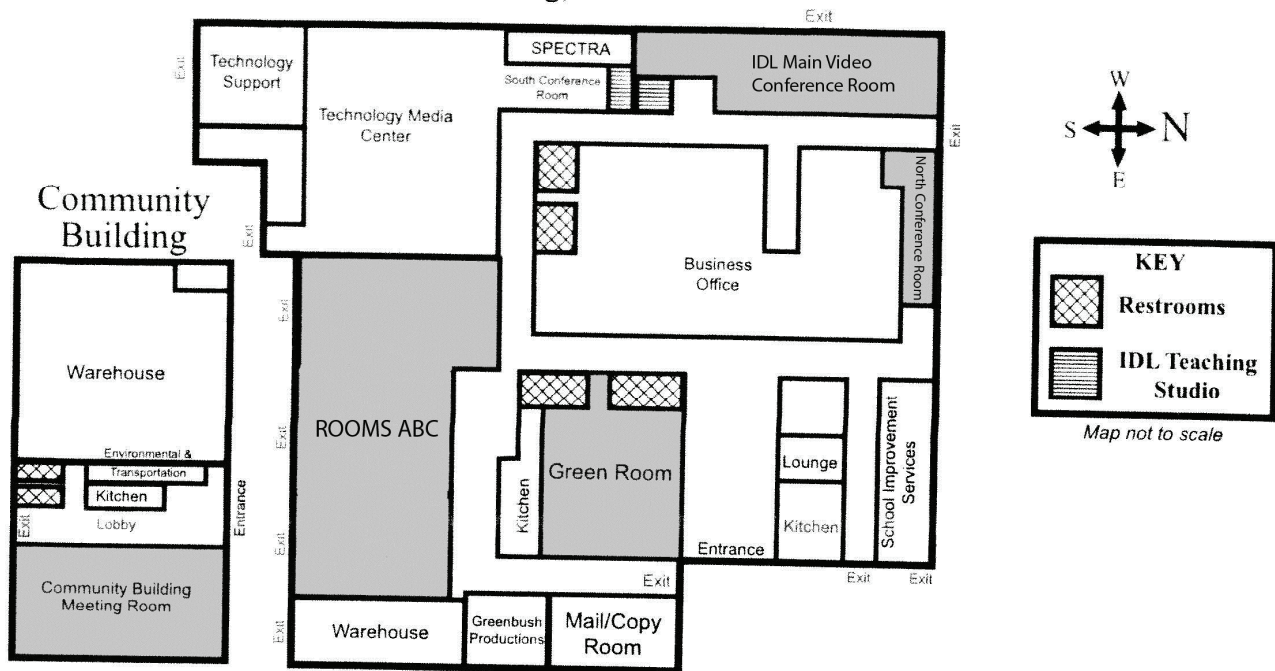

R.V. Haderlein Building

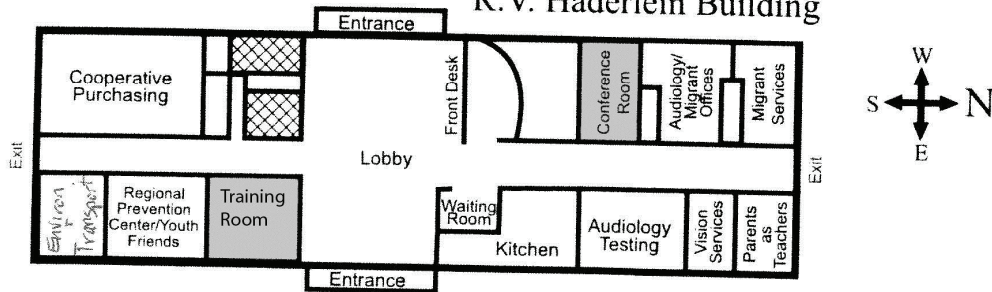

Abernathy Science Education Center

